

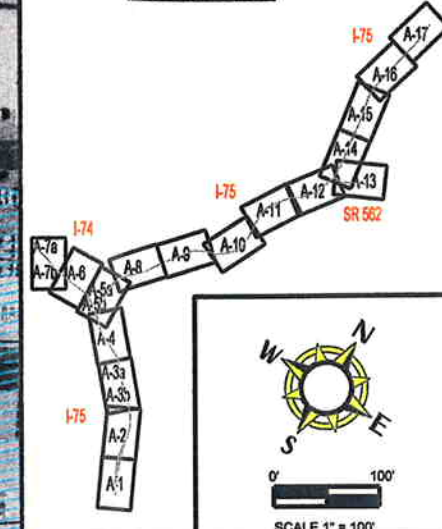

MILL CREEK EXPRESSWAY HAM-75-2.30 PID#76257

SHEET KEY



MAP LEGEND

- CONCEPTUAL ALTERNATIVE
- EXISTING RIGHT OF WAY
- CONSTRUCTION LIMITS
- RETAINING WALL
- ELEC. TRANSMISSION TOWER
- FLOODWAY
- 100-YR FLOOD PLAIN
- WETLAND
- HISTORIC DISTRICT
- HISTORIC PROPERTY FOR FURTHER INVESTIGATION
- CEMETERY
- POTENTIAL BUILDING DEMOLISHED
- RAMP CLOSED

4 LANE CONTINUITY ALTERNATIVE



PDP STEP 5
MARCH
2006

A-10

