

**MILL CREEK EXPRESSWAY**  
**HAM-75-2.30 PID#76257**

**SHEET KEY**

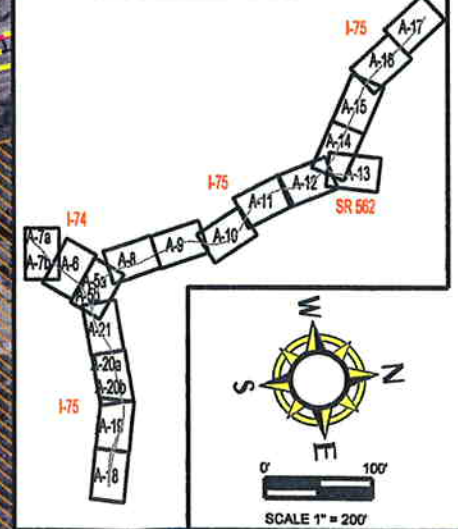

**MAP LEGEND**

- CONCEPTUAL ALTERNATIVE
- EXISTING RIGHT OF WAY
- ELEC. TRANSMISSION TOWER
- CONSTRUCTION LIMITS
- RETAINING WALL
- HISTORIC DISTRICT
- HISTORIC PROPERTY FOR FURTHER INVESTIGATION

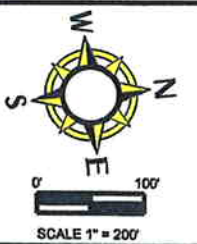

**5/4 LANE ALTERNATIVE**



TRANSYSTEMS

PDP STEP 5  
 MARCH  
 2006

**A-18**