

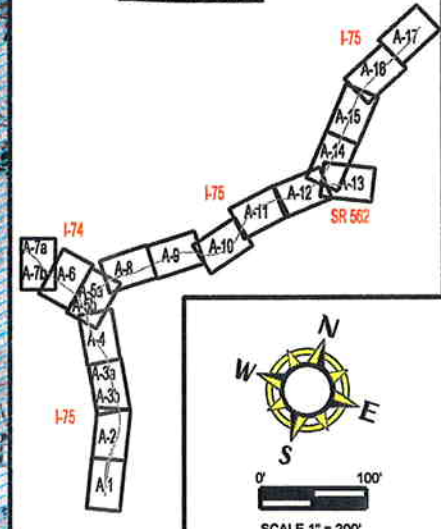

**MILL CREEK EXPRESSWAY**  
**HAM-75-2.30 PID#76257**

**SHEET KEY**



**MAP LEGEND**

- CONCEPTUAL ALTERNATIVE
- EXISTING RIGHT OF WAY
- CONSTRUCTION LIMITS
- EXISTING RAILROAD
- POTENTIAL NEW RAILROAD MAIN
- RETAINING WALL
- ELEC. TRANSMISSION TOWER
- FLOODWAY
- 100-YR FLOOD PLAIN
- CULVERT
- PAST OR POTENTIAL LANDSLIDE
- HISTORIC DISTRICT
- PARK LAND



0' 100'  
 SCALE 1" = 200'

**4 LANE CONTINUITY ALTERNATIVE**



TRANSYSTEMS

PDP STEP 5  
 MARCH  
 2006

**A-8**

